



CUSTOM-MADE REPLACEMENT SCREENS

Windows



Made to your specific size (measured corner to corner, width by height).

***5/16" Thickness- Compatible with most exterior windows.**

***Sturdy 3/4" Wide Aluminum Frame with 3/4" Plastic Corners and Steel Spring Clips.**

***Frame Colors available in White or Mill (finished aluminum)**

Black Fiberglass Screen Cloth

All custom-made screens are special order and there are no returns.

Replacement Screen Prices are priced by United Inches (width added to height, each rounded up to the nearest inch).

Example: The actual screen measures 29.5" wide x 26.5" tall, corner to corner. 30" (rounded up from 29.5") + 27" (rounded up from 26.5") = 57 United Inches.

Please allow 3-4 weeks for shipping!

WINDOW SCREEN COMPONENTS

3/4" Wide Aluminum Screen Frame



***12' 6" length- 3/4" Wide- 5/16" Thick- Cuts easily with a hacksaw. For use with 3/4" corners.**

◀ **85925- Mill Finish**
85925-W- White Finish ▶



◀ 3/4" Plastic Screen Corners

***5/16" thick- Exposed square including bumps is 3/4" x 3/4". Each insert is 1 1/2" long. Overall length and height is 2".**

85926-GB- Grey Finish
85926-WB- White Finish



◀ **85927- 100' Roll Screen Spline String- Black Rubber**
85927-FT- Screen Spline sold by the foot



▲ **85929- 36" x 100' Roll Screen Cloth (Charcoal Finish)**

85929-FT- 36" Screen Cloth sold by the foot - order just what you need to fix one or two screens.



▲ **85928- Screen Retention Clip (Mill Finish)**



▲ **85950- Plastic Spline Insert Tool**

5/8" Plastic Screen Corners

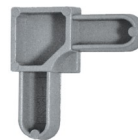

***5/16" thick- Exposed square is 5/8" x 5/8". Each insert is 1 1/2" long. Overall length and height is 1 1/2".**

◀ **85926- Grey Finish**
85926-W- White Finish ▶

